

--- = APPROX. AGV PATHWAY (>12,000LF)  
 - - - = LAN CABLING MAP (DESTINATIONS)

SYSTEM OVERVIEW

- (1) BATTERY AREA
- (5) SERVICE AREAS:
  - \* KITCHEN
  - \* COMMISSARY
  - \* TRASH
  - \* LAUNDRY
  - \* WAREHOUSE
- (4) PICK UP/DELIVERY AREAS
  - \* TTR (NEAR CP7)
  - \* STAFF DINING (NEAR CP48)
  - \* INFIRMARY
  - \* INFIRMARY
- (18) HOUSING UNITS
- (2) CONTROL POINTS
  - \* CP7
  - \* CP48

Drawings and specifications as instruments of service are and shall remain the property of the architect whether the project for which they are made is executed or not. They are not to be used by the owner or other persons or extensions to this project except by agreement in writing and with appropriate compensation to the architect.

DATE: 11-30-88  
 REVISED: 12-9-88  
 12-18-88  
 1-10-89 A

JOB NO: 88-115  
 DRAWN BY: S.M.-J.O.B.  
 CHECKED:

SCALE: NONE

FOR CONSTRUCTION

CONTENTS:

SITE PLAN

SHEET NO.

**LEGEND:**

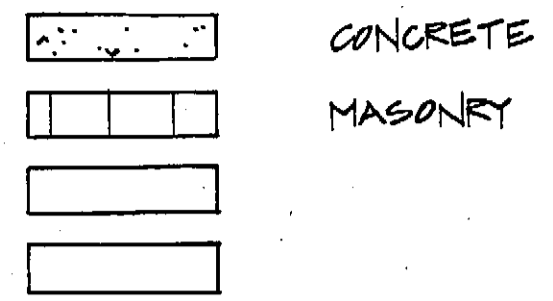

**SYMBOLS:**

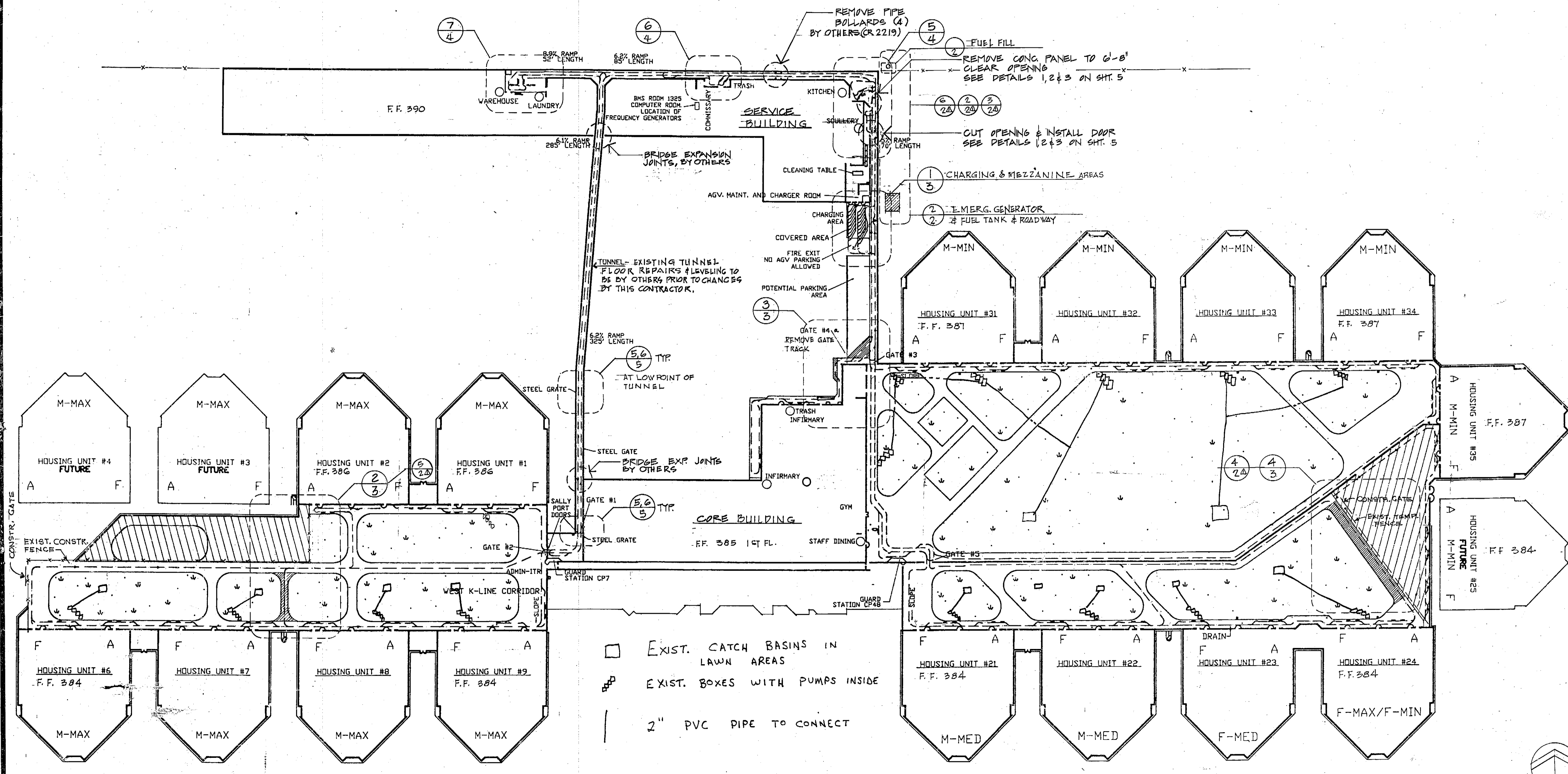
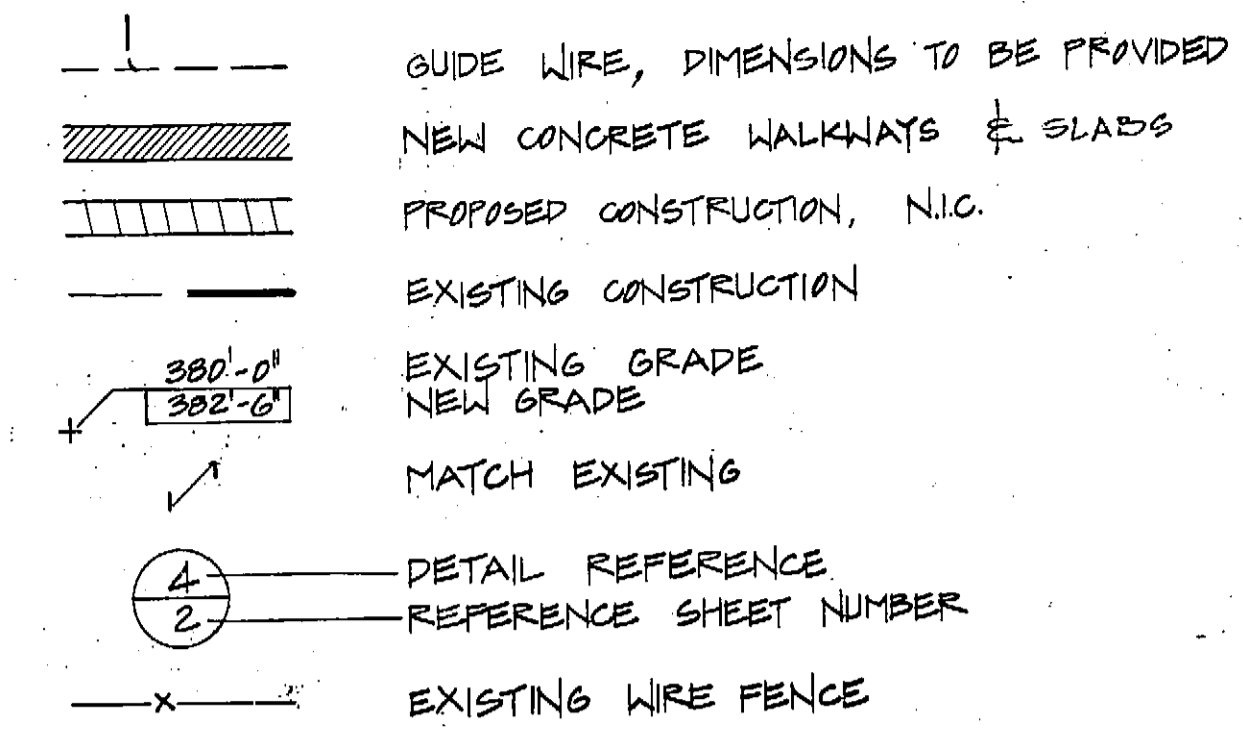

SITE PLAN

SITE PLAN

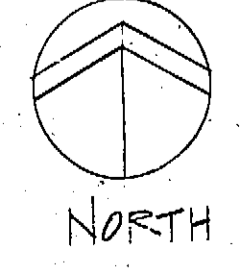

DATE	REV	DESCRIPTION	DRAWN	ENGR
6/28/89	A	PROD PRINT	SKC	
10/12/89	B	ADDED MAGIC POINTS/VVA		

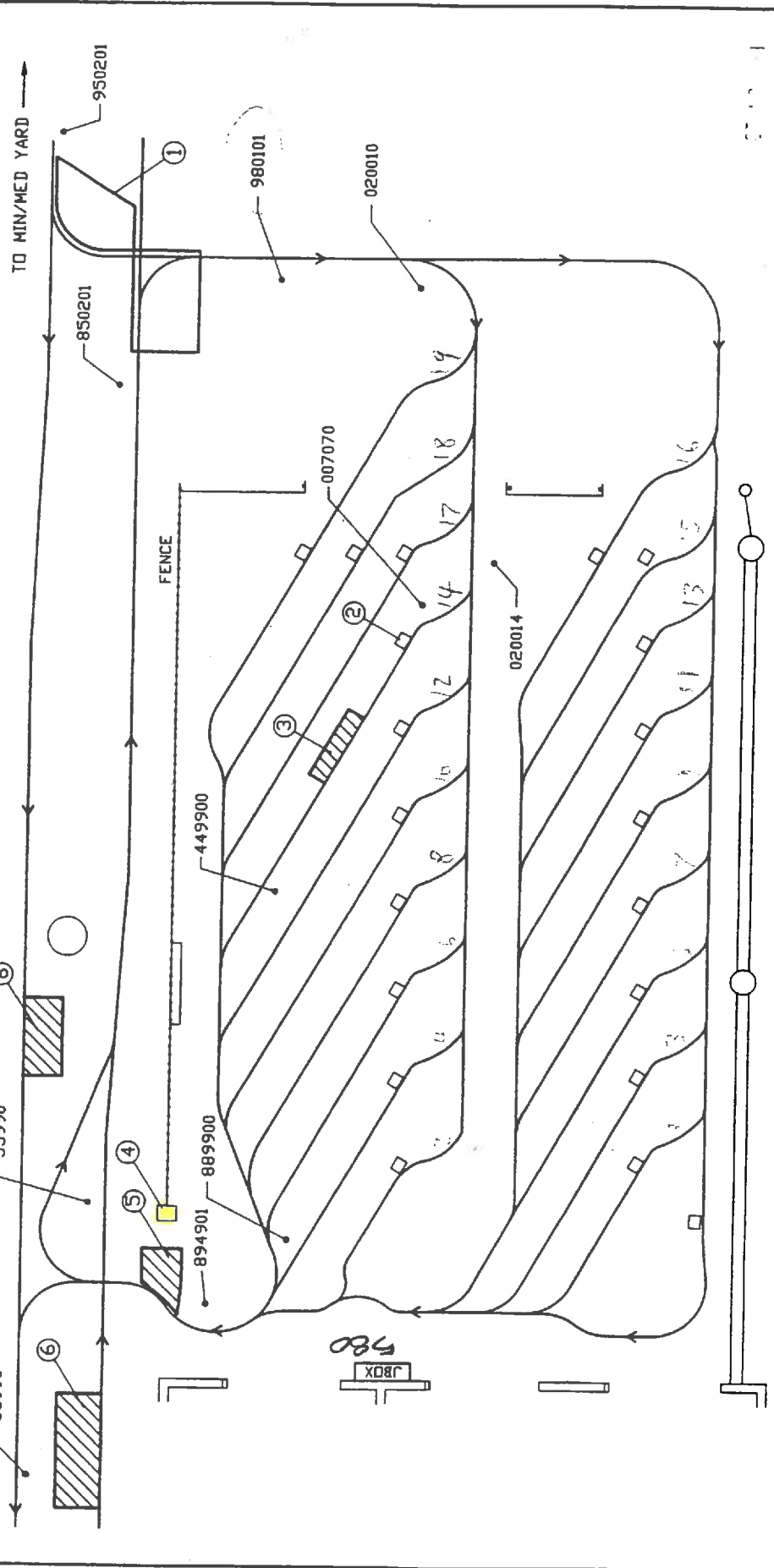

DATE: 6/28/89	JOB #: 135	SCL: 1/70
PLS BY: SKC	DWN BY: SKC	
TOL: .XX ± .06	.XXX ± .020	
<b>APOGEE ROBOTICS</b>		
TITLE: GUIDE PATH BATTERY AREA		
DVG NO: B-5100-0165		

- NOTES:
- (1) ENTRANCE VSU BLOCKING LOOP
  - (2) CHARGING CONTACT
  - (3) PARKING F 4
  - (4) IR LINK
  - (5) IR F 4
  - (6) TUNNEL F 4

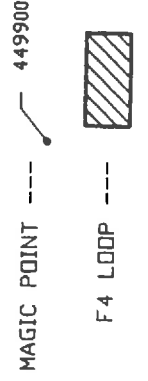
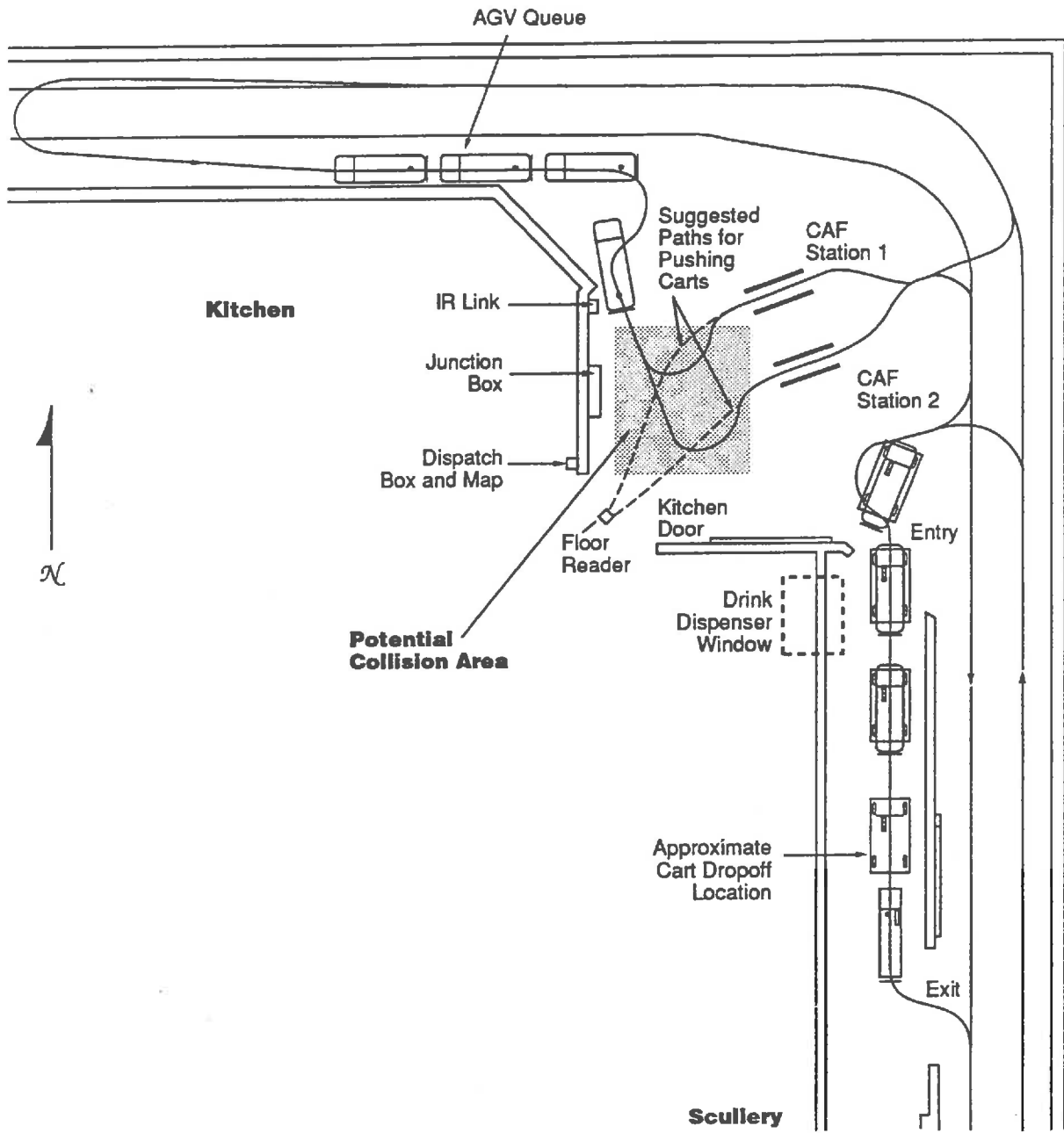
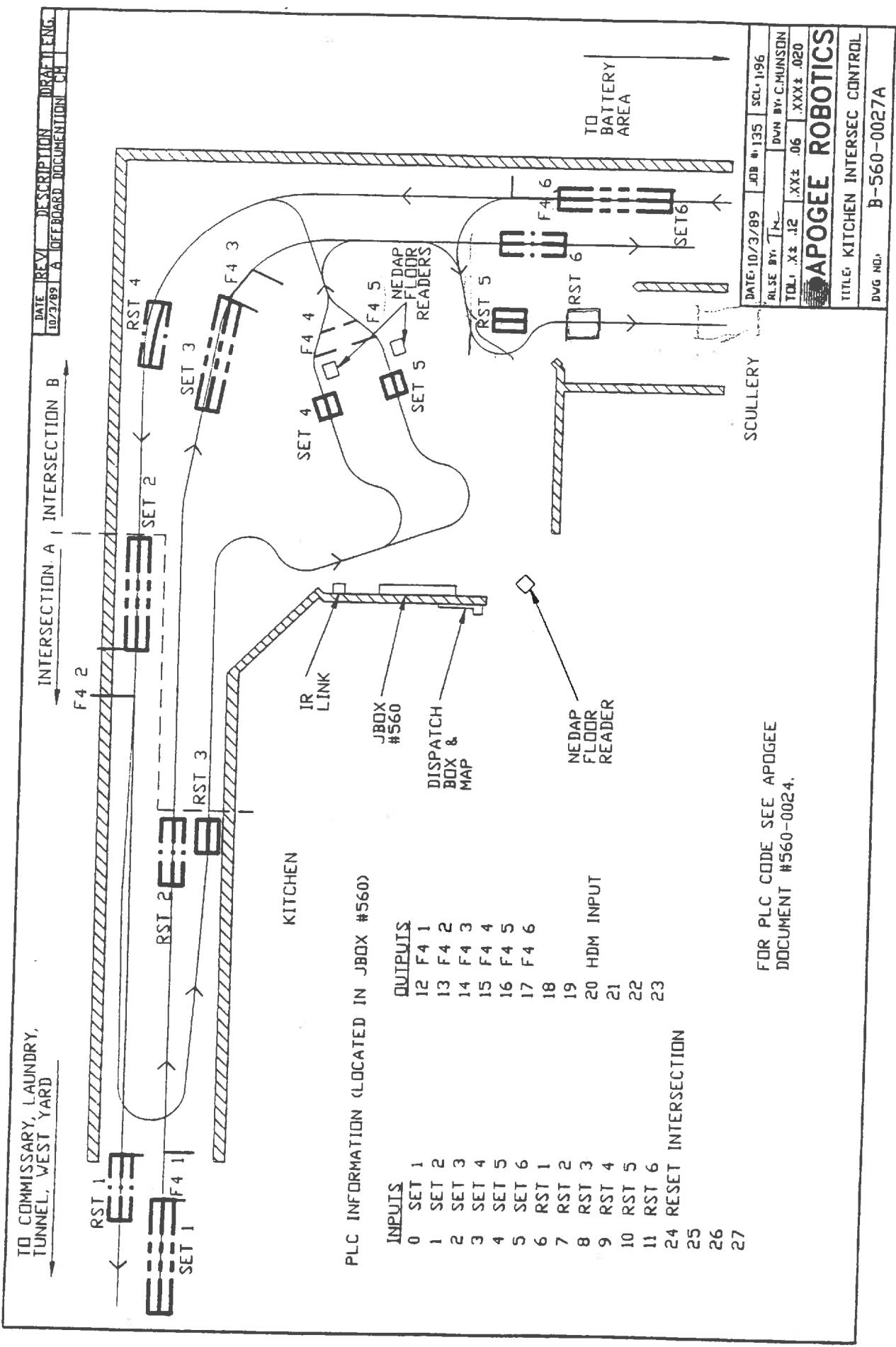

Figure 3-6 Battery Area



**Figure 2-1 Kitchen/Scullery Service Area**



FOR PLC CODE SEE APOGEE DOCUMENT #560-0024.

DATE: 10/3/89	JOB #: 135	SCL: 196
ALSO BY: T.K.	DVN BY: C.HUNSON	
TOL: .XX ± .12	.XX ± .06	.XXX ± .020
<b>APOGEE ROBOTICS</b>		
TITLE: KITCHEN INTERSEC CONTROL		
DWG NO.:	B-560-0027A	

Figure 3-14 Kitchen Intersection Control

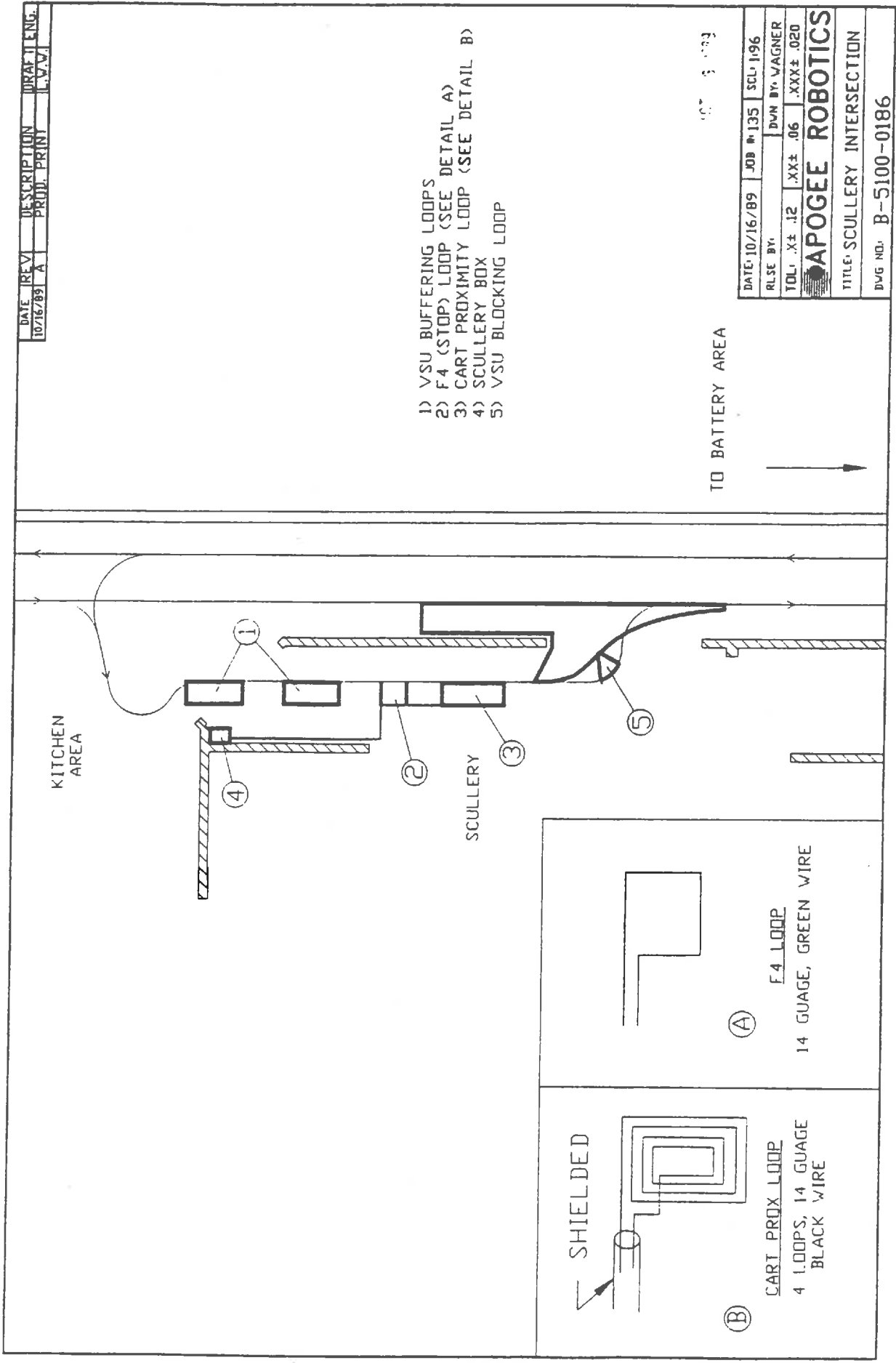

Figure 3-15 Scullery Intersection Operation

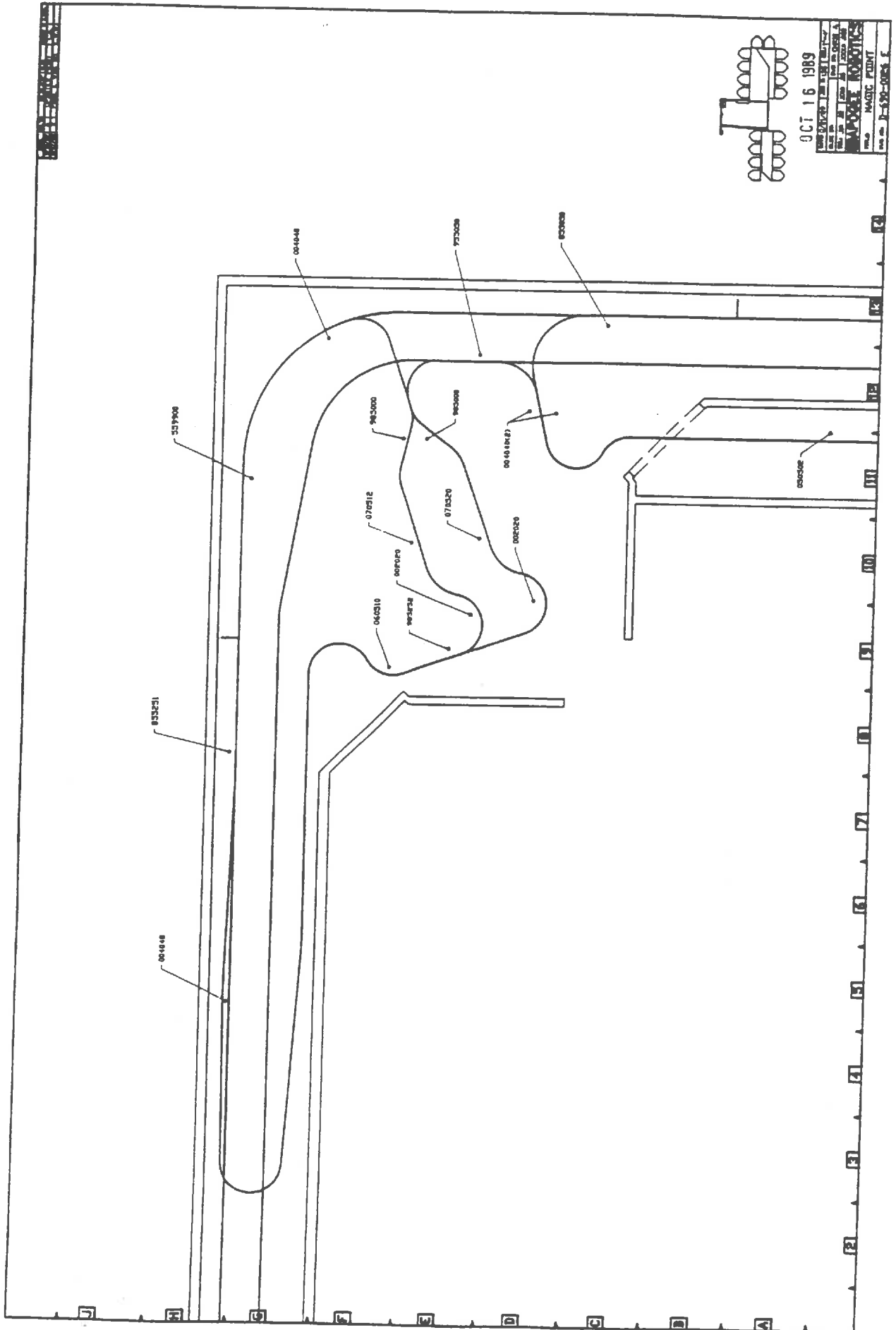
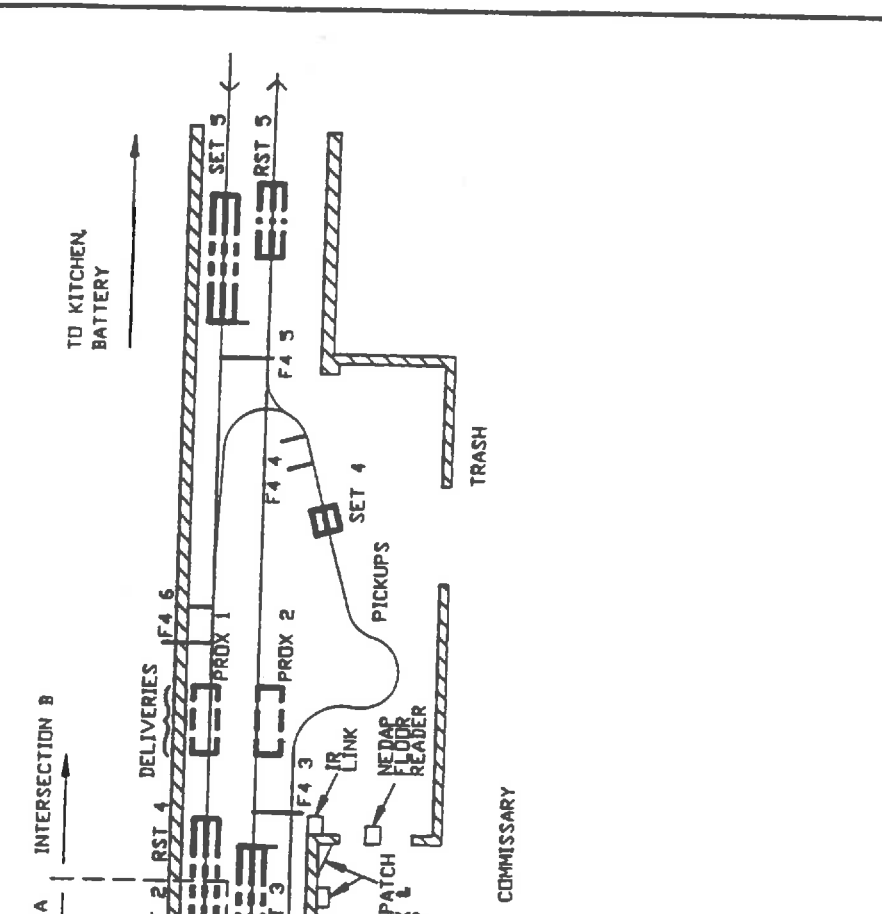

Figure 3-16 Kitchen Magic Points



PLC INFORMATION (LOCATED IN JBOX #520)

INPUTS	OUTPUTS
0	SET 1
1	SET 2/RST 4
2	SET 3
3	SET 4
4	SET 5
5	PROX 1
6	RST 1
7	RST 2
8	RST 3
9	RST 5
10	PROX 2
11	RST INT A
24	RST INT B
25	
26	
27	
12	F4 1 OFF
13	F4 2 OFF
14	F4 3 OFF
15	F4 4 OFF
16	F4 5 OFF
17	F4 6 ON
18	CART @ PROX 1
19	CART @ PROX 2
20	HDM INPUT
21	
22	
23	

FOR PLC CODE SEE APOGEE DOCUMENT #560-0026.

DATE: 10/3/89	JOB # 135	SOL: M20
PLSE BY: [Signature]	DWN BY: CLANSON	
TITLE: X: 12	:XX: 06	JXX: J020
<b>APOGEE ROBOTICS</b>		
TITLE: COMM/TRASH INTERSEC CONTROL		
DWG NO: B-560-0027B		

Figure 3-25 Commissary/Trash Intersection



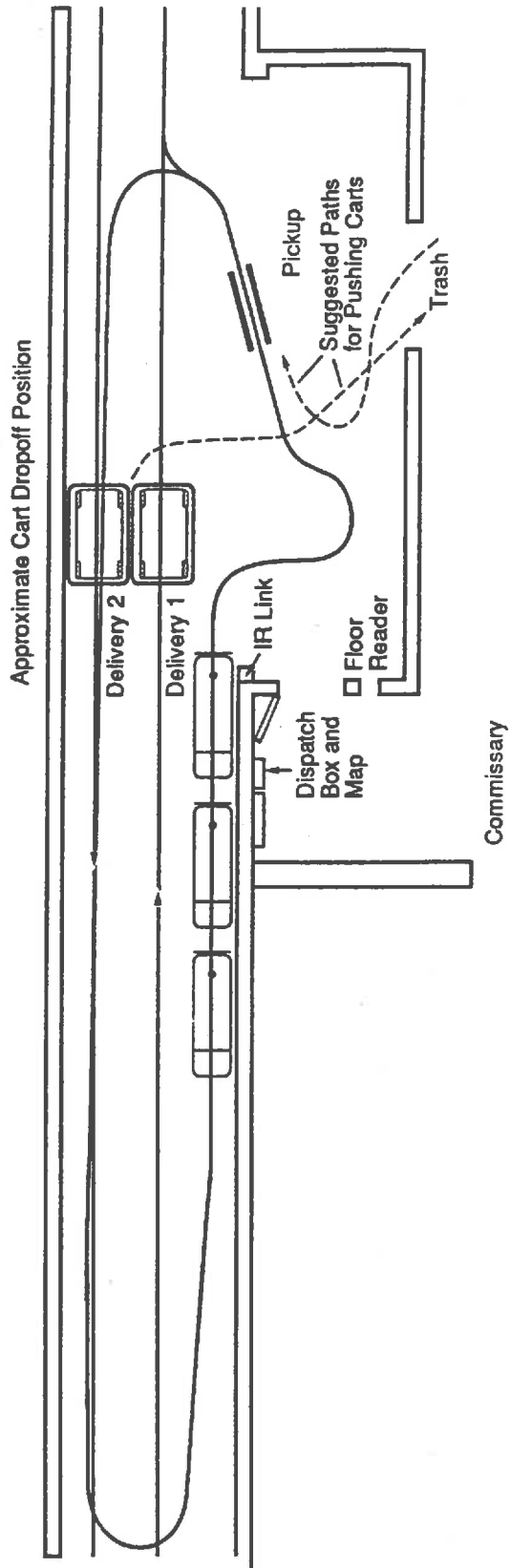

**Figure 6-1 Trash Service Area / Commissary**

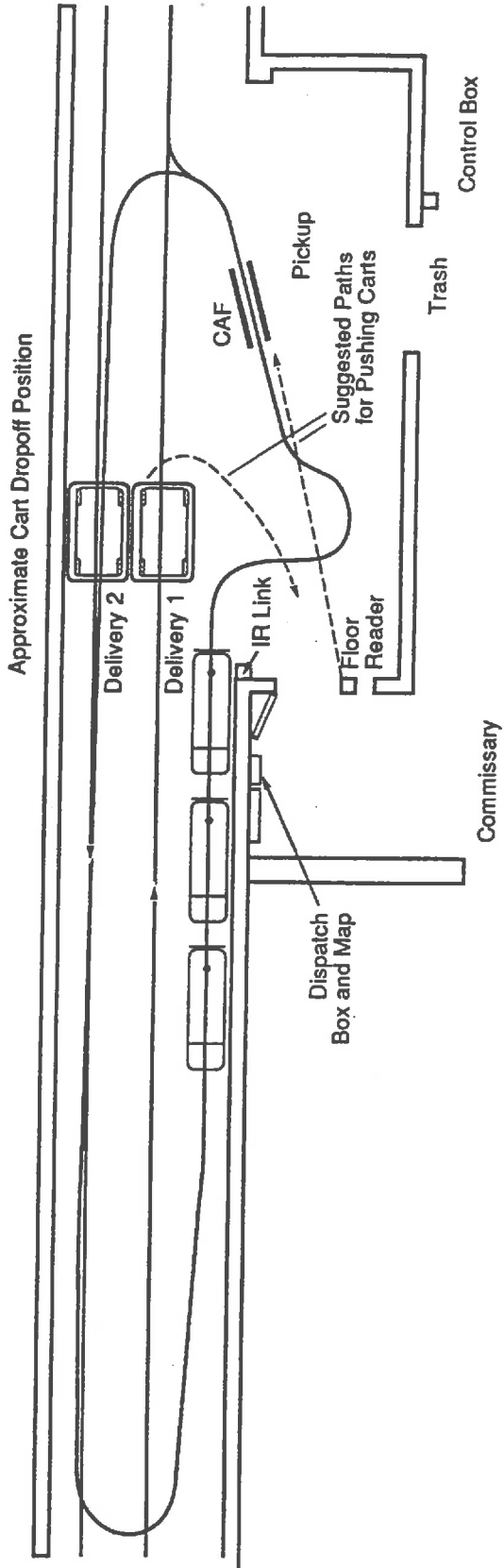
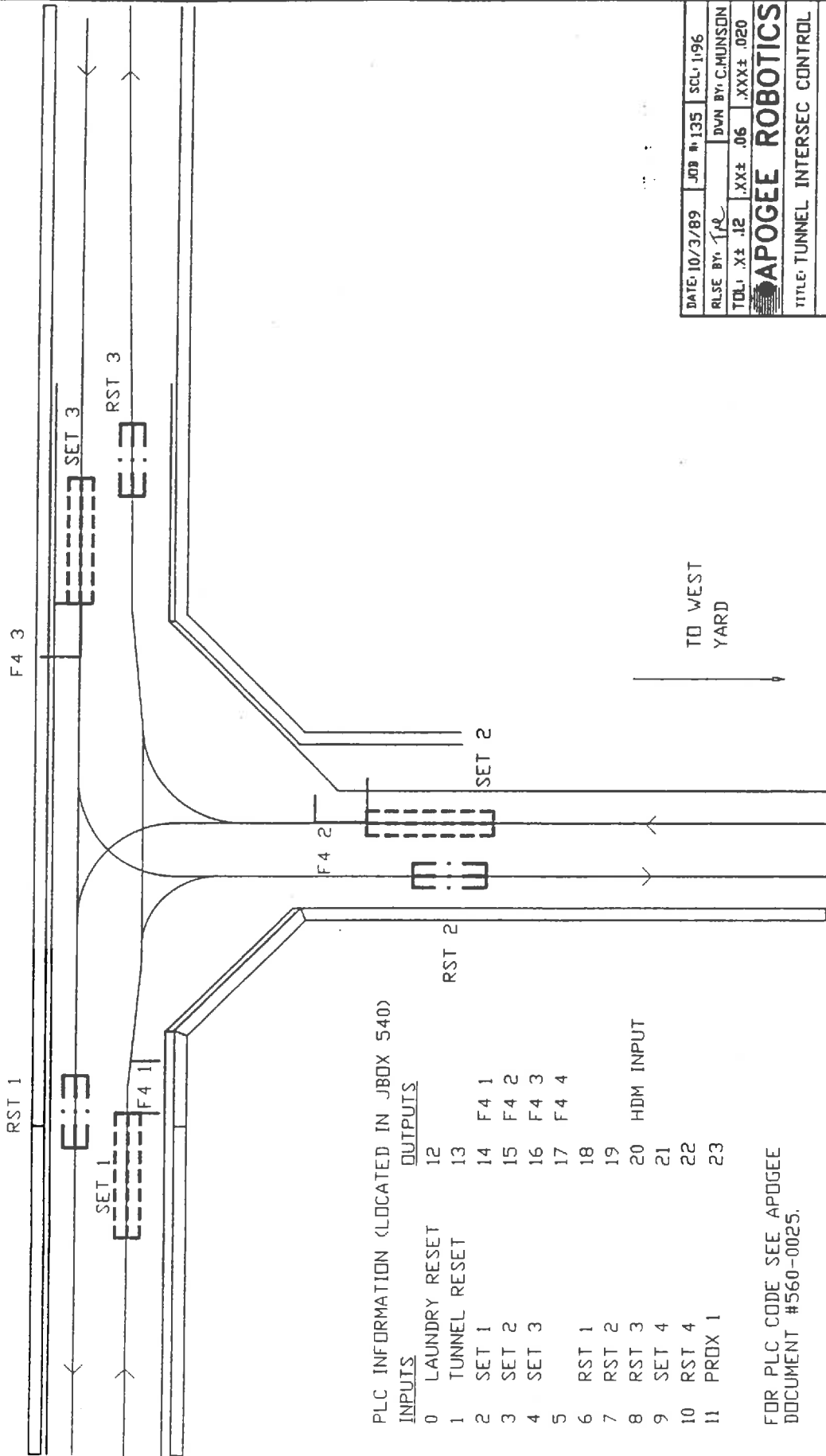

**Figure 3-1 Commissary / Trash Area**

DATE	REV	DESCRIPTION	DRAWN BY	ENG.
10/3/89	A	OFFBOARD DOCUMENTATION	CM	

TO LAUNDRY/WAREHOUSE

TO KITCHEN, BATTERY



PLC INFORMATION (LOCATED IN JBOX 540)

INPUTS	OUTPUTS
0 LAUNDRY RESET	12
1 TUNNEL RESET	13
2 SET 1	14 F4 1
3 SET 2	15 F4 2
4 SET 3	16 F4 3
5	17 F4 4
6 RST 1	18
7 RST 2	19
8 RST 3	20 HDM INPUT
9 SET 4	21
10 RST 4	22
11 PROX 1	23

FOR PLC CODE SEE APOGEE DOCUMENT #560-0025.

TO WEST YARD

DATE: 10/3/89 JOB #: 135 SCL: 1/96

RLSE BY: JAL DWN BY: C. MUNSON

TOL: .XX± .12 .XX± .06 .XXX± .020

**APOGEE ROBOTICS**

TITLE: TUNNEL INTERSEC CONTROL

DWG NO: B-560-0027C

TUNNEL INTERSECTION

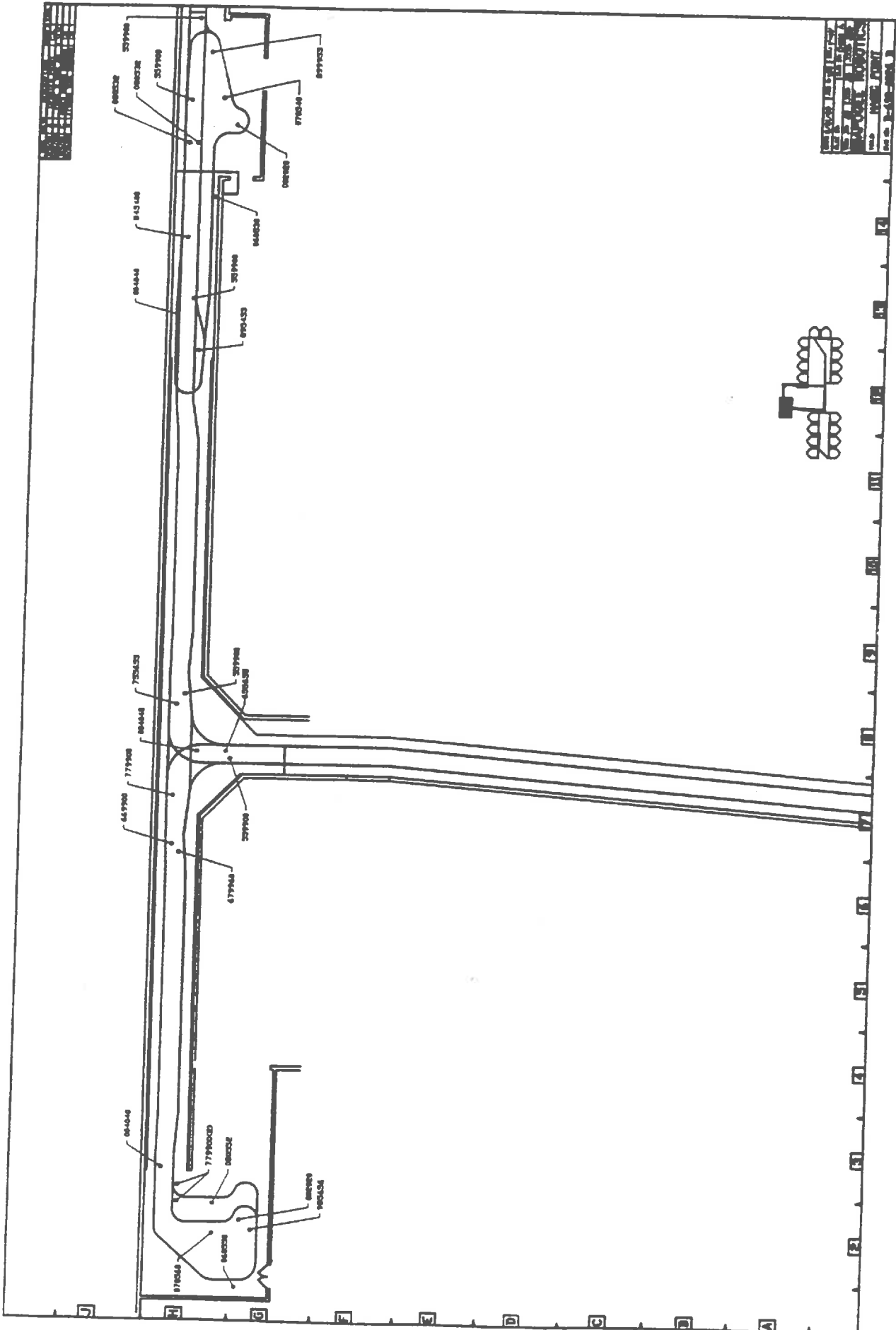
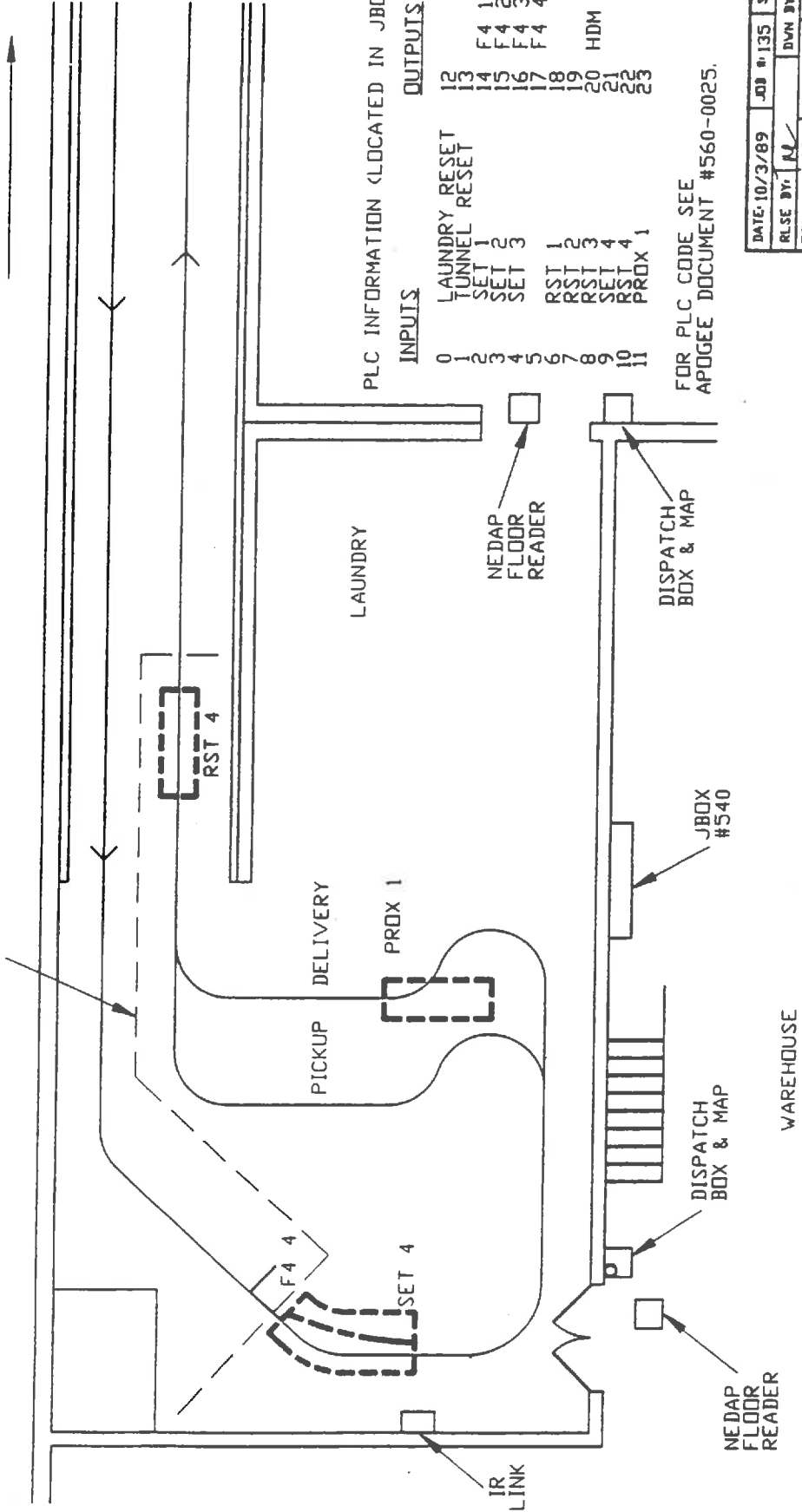

Figure 3-21 Service Building Magic Points

DATE	REV	DESCRIPTION	DRAWN BY
10/3/89	A	DEBOARD	CH

TO TUNNEL COMMISSARY,  
KITCHEN, BATTERY

LAUNDRY INTERSECTION



LAUNDRY

PICKUP DELIVERY

PROX 1

SET 4

RST 4

NEDAP FLOOR READER

DISPATCH BOX & MAP

WAREHOUSE

NEDAP FLOOR READER

JBOX #540

DISPATCH BOX & MAP

PLC INFORMATION (LOCATED IN JBOX #540)

INPUTS

- 0 LAUNDRY RESET
- 1 TUNNEL RESET
- 2 SET 1
- 3 SET 2
- 4 SET 3
- 5 RST 1
- 6 RST 2
- 7 RST 3
- 8 RST 4
- 9 SET 4
- 10 RST 4
- 11 PROX 1

OUTPUTS

- 12 F4 1
- 13 F4 2
- 14 F4 3
- 15 F4 4
- 16 F4 3
- 17 F4 4
- 18 HDM INPUT
- 19
- 20
- 21
- 22
- 23

FOR PLC CODE SEE  
APOGEE DOCUMENT #560-0025.

DATE: 10/3/89	JOB # 135	SCALE: 1/72
RELEASE BY: CH	DESIGNED BY: C. MUNSON	
TOLERANCE: .12	SCALE: .06	XXX ± .020
<b>APOGEE ROBOTICS</b>		
TITLE: LAUNDRY INTERSECTION CONTROL		
DWG NO.: B-560-0027D		

Figure 3-20 Laundry/Warehouse Intersection

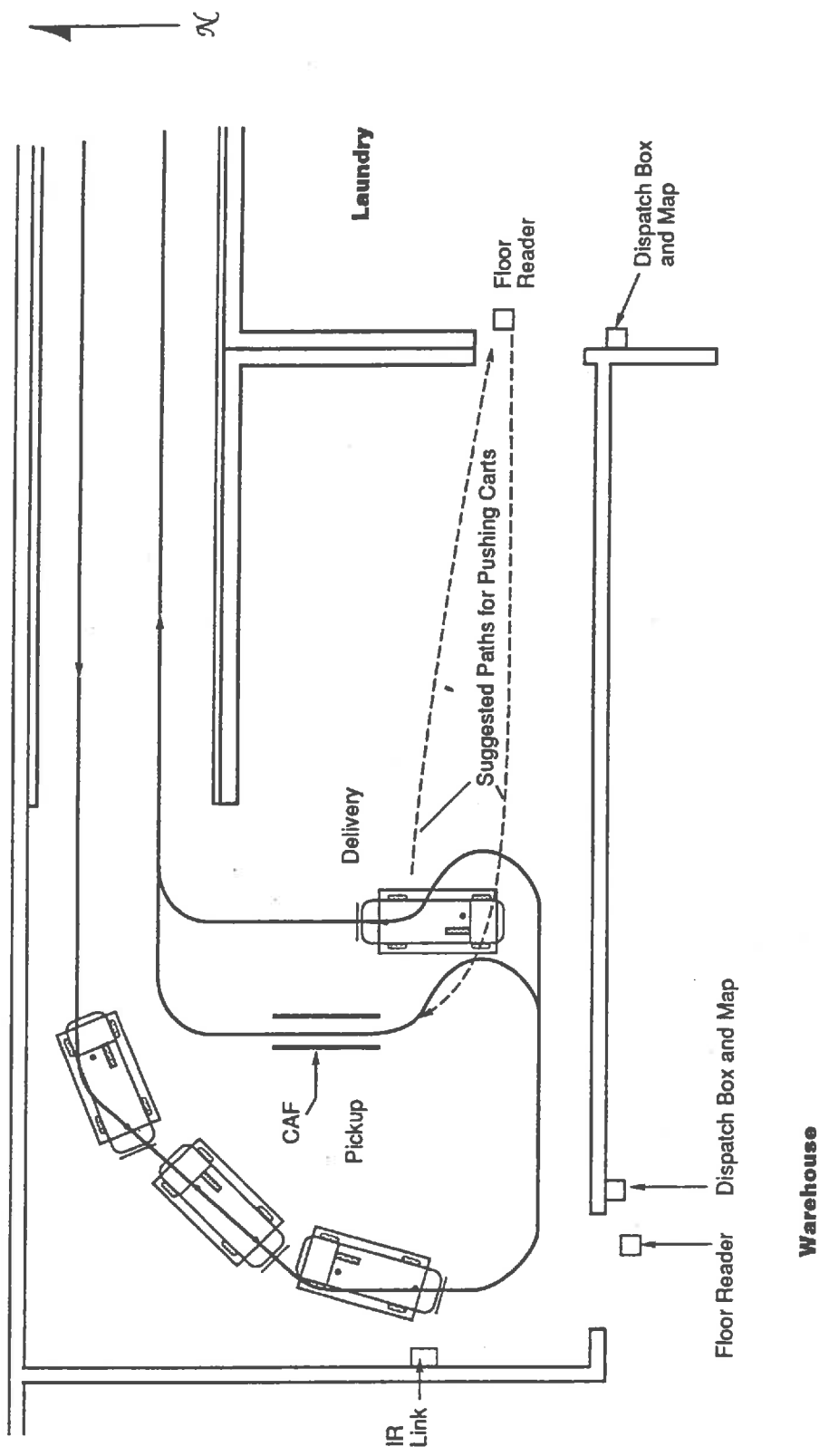

**Figure 4-1 Laundry / Warehouse Service Areas**

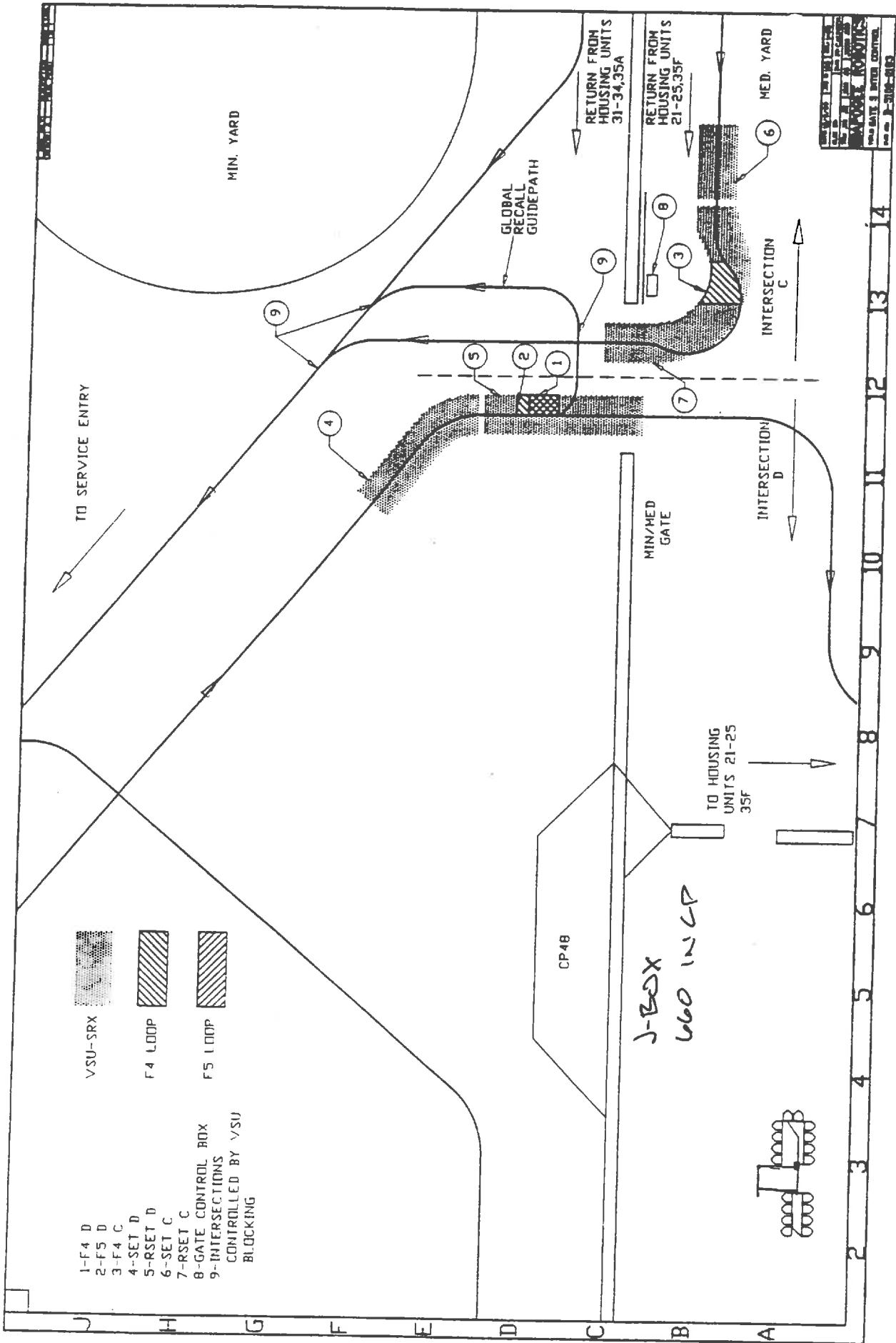
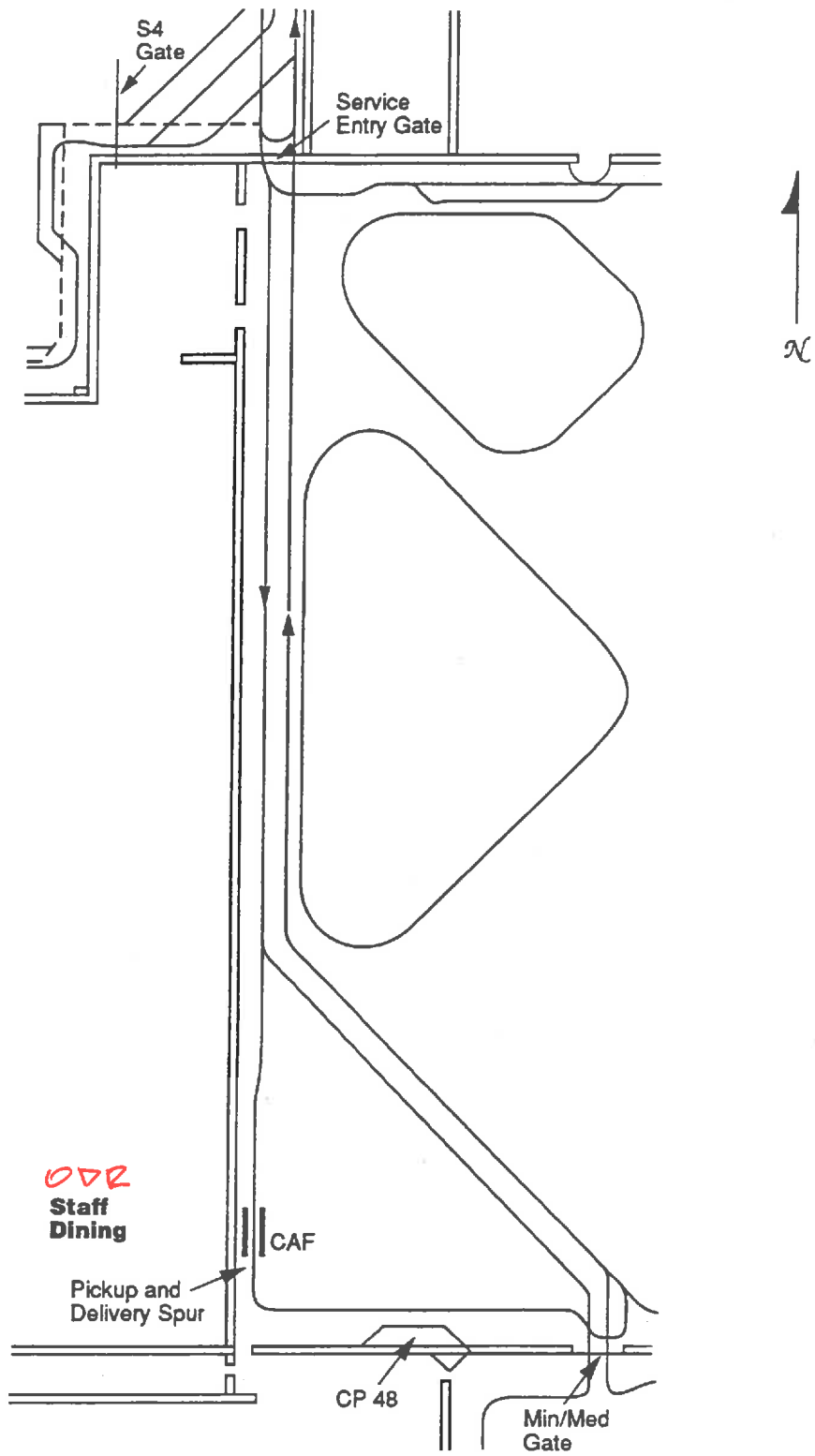

Figure 3-33 Min/Med Gate

CP 48



**Figure 8-2 CP48 Layout**



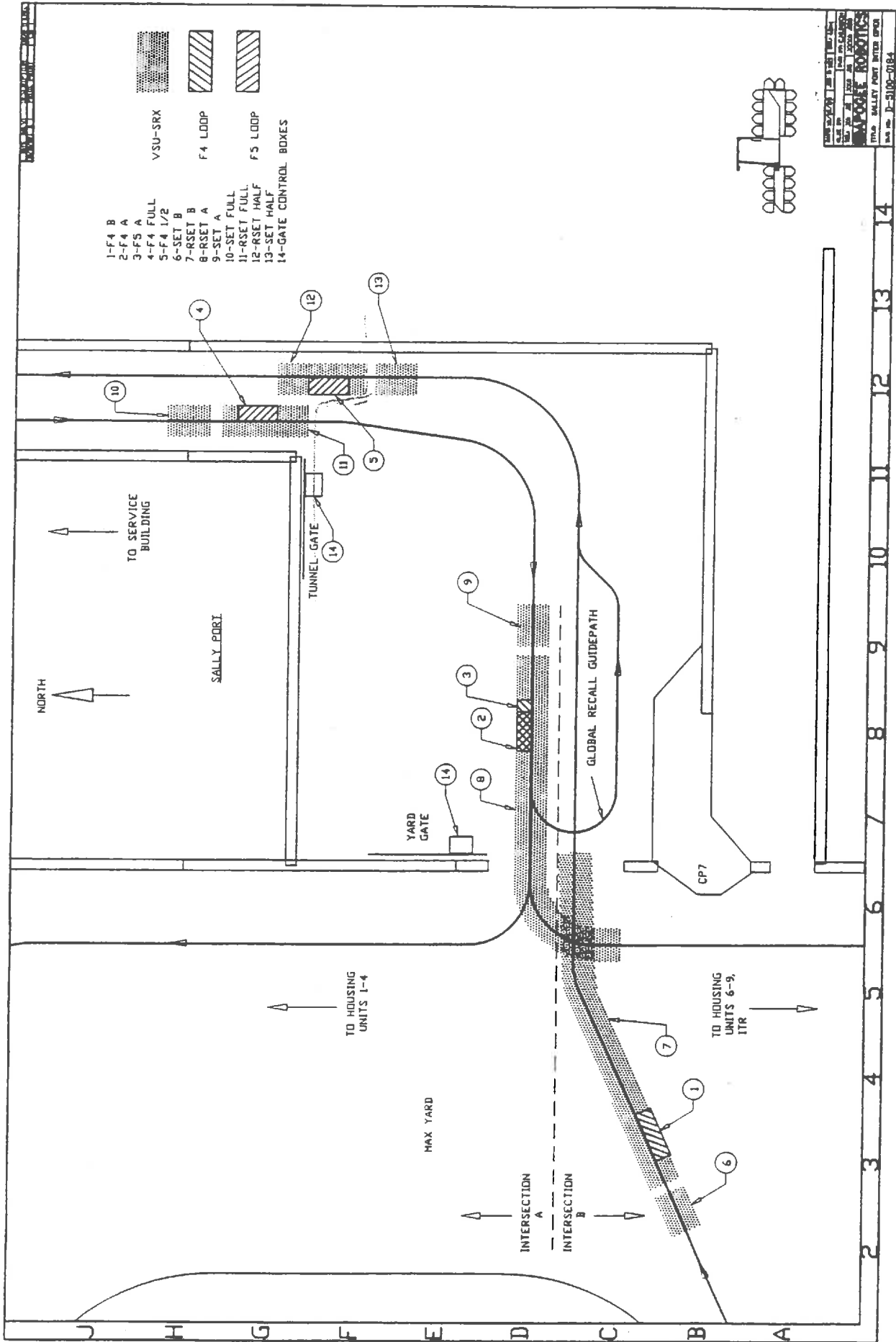
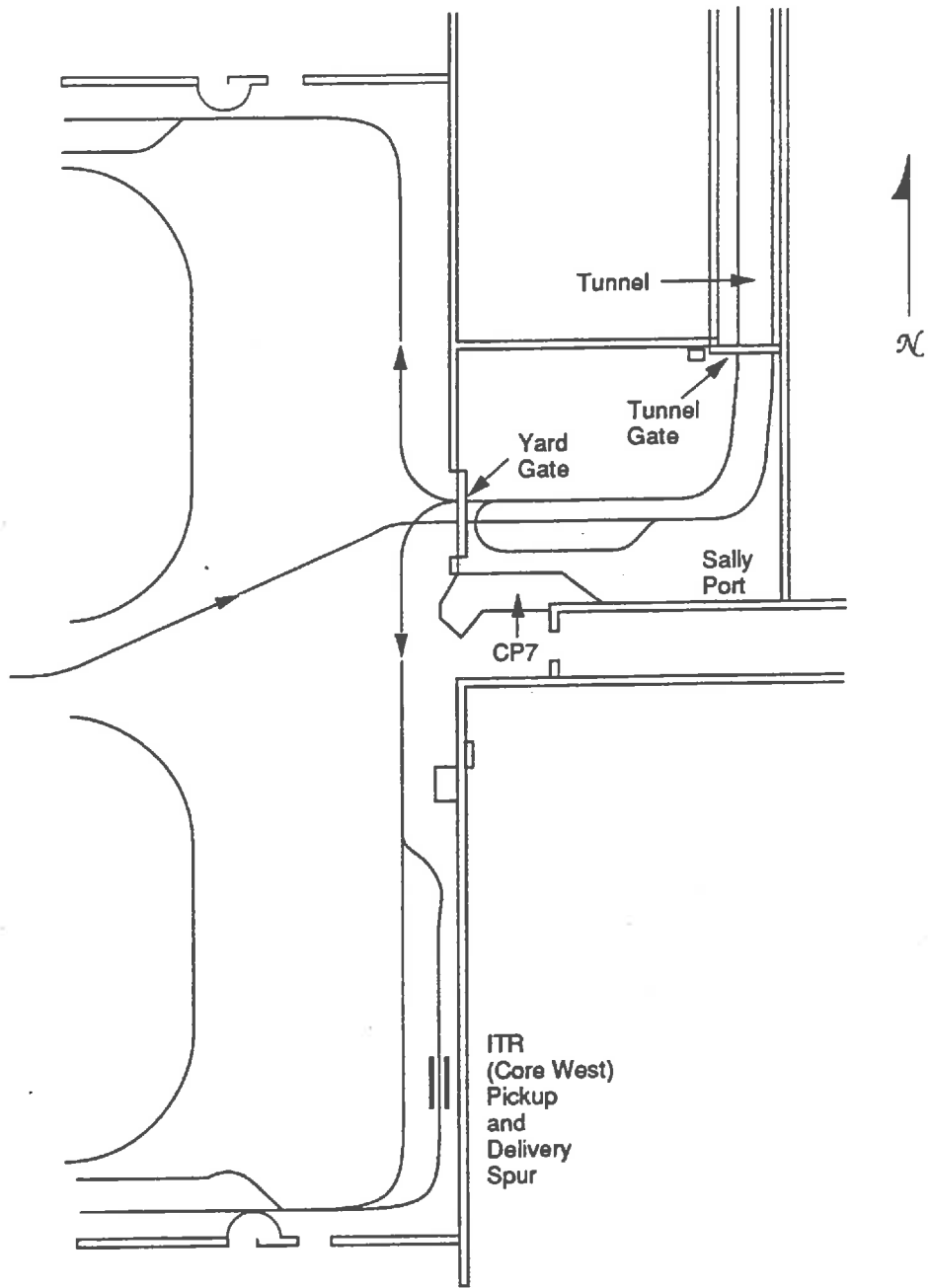
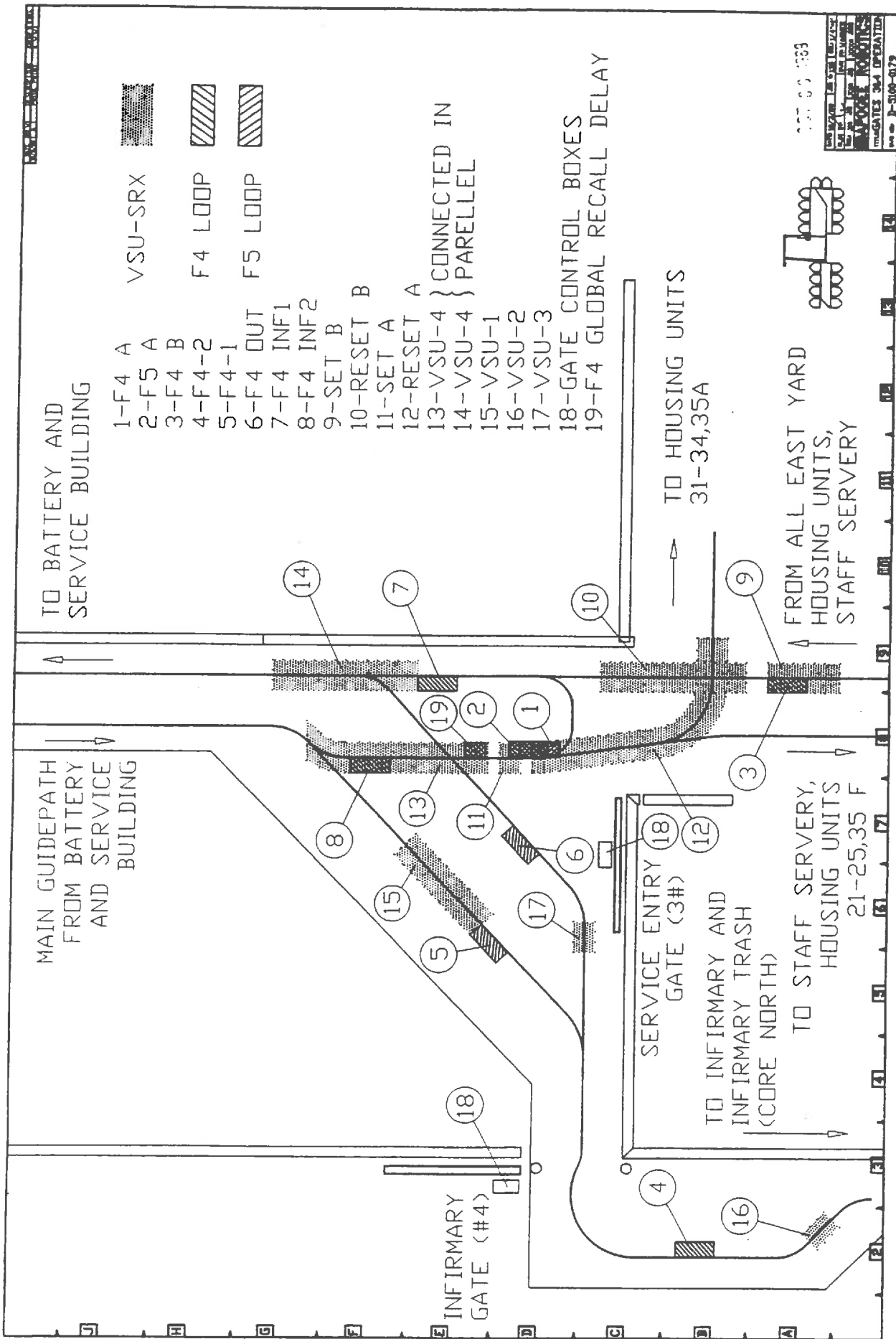

Figure 3-30 Sally Port

CP7



**Figure 7-3 ITR (Core West) Spur**



TO BATTERY AND SERVICE BUILDING

MAIN GUIDEPATH FROM BATTERY AND SERVICE AND SERVICE BUILDING

- 1-F4 A
- 2-F5 A
- 3-F4 B
- 4-F4-2
- 5-F4-1
- 6-F4 OUT
- 7-F4 INF1
- 8-F4 INF2
- 9-SET B
- 10-RESET B
- 11-SET A
- 12-RESET A
- 13-VSU-4 } CONNECTED IN
- 14-VSU-4 } PARELLEL
- 15-VSU-1
- 16-VSU-2
- 17-VSU-3
- 18-GATE CONTROL BOXES
- 19-F4 GLOBAL RECALL DELAY

- VSU-SRX
- F4 LOOP
- F5 LOOP

SERVICE ENTRY GATE (3#)

TO INFIRMARY AND INFIRMARY TRASH (CORE NORTH)

TO STAFF SERVERY, HOUSING UNITS 21-25,35 F

TO HOUSING UNITS 31-34,35A

FROM ALL EAST YARD HOUSING UNITS, STAFF SERVERY

SERVICE ENTRY GATE

DATE: 12/15/83  
 DRAWN BY: J. W. HARRIS  
 CHECKED BY: J. W. HARRIS  
 PROJECT: 344 OPERATOR  
 SHEET: P-3100-017

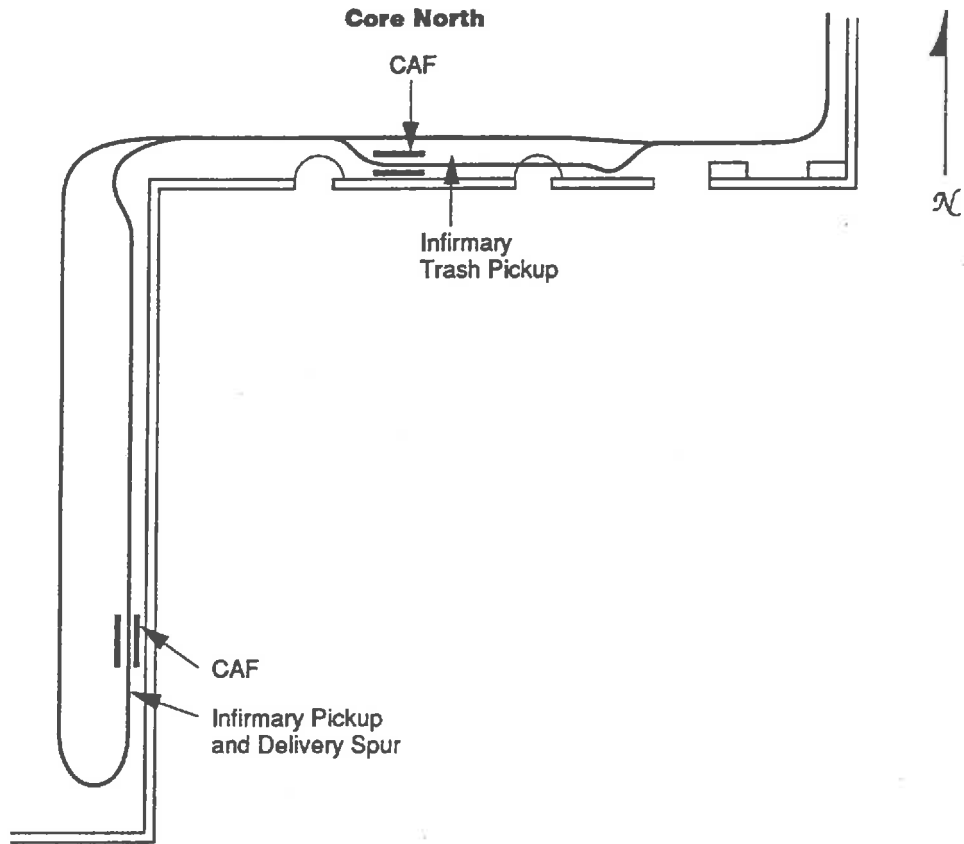

**Figure 7-2 Infirmery Layout**

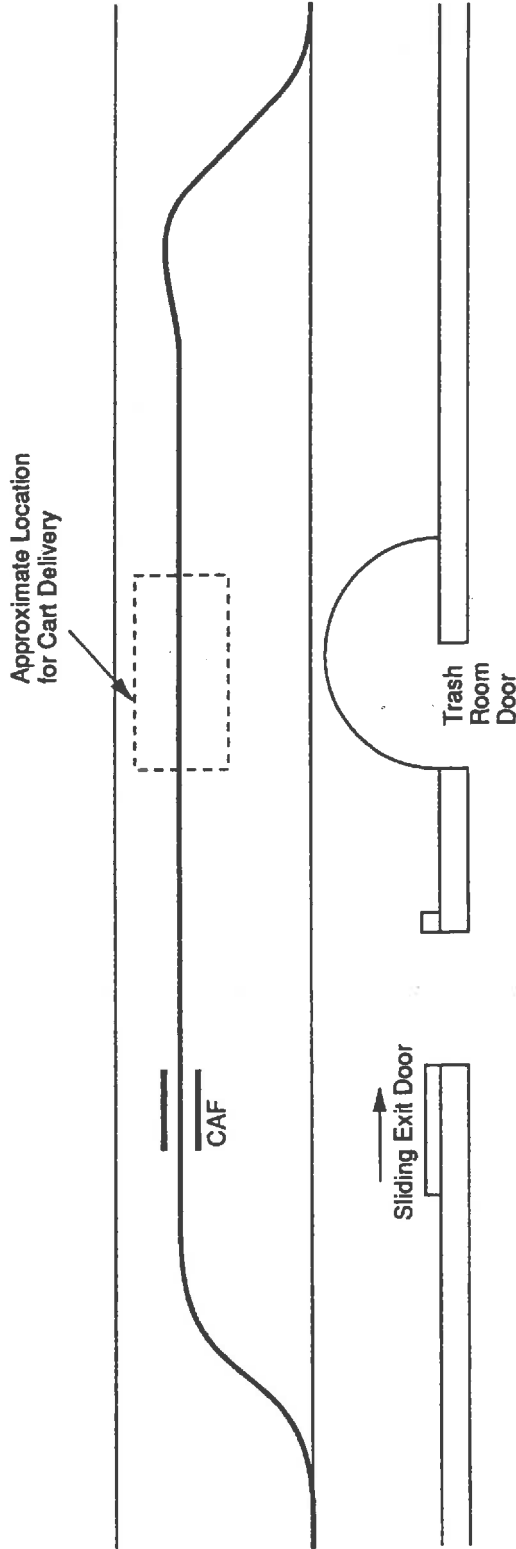



**Figure 7-1 Typical Housing Unit Pickup and Delivery Spur**

DATE	REV	DESCRIPTION	DRAWN BY	ENGR.
10/12/89	A	PROJ. PRINT	WVA	

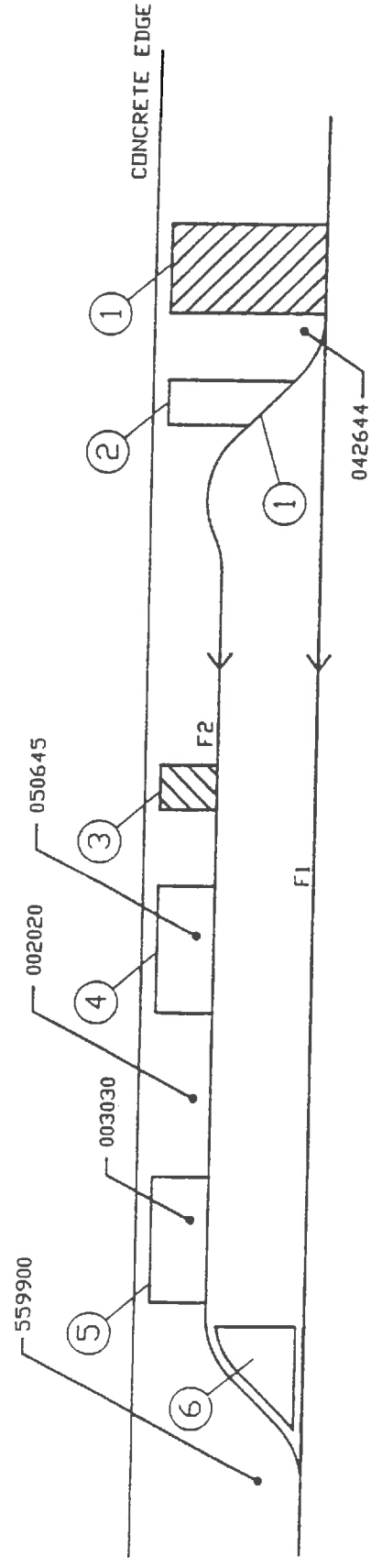
EXAMPLE OF P&D LOOP, HOUSING UNIT #9



-  F 4 LOOP
-  F 5 LOOP
-  MAGIC POINTS

- NOTES:
- (1) F5 AT ENTRANCE
  - (2) F5 OFF PROX LOOP
  - (3) CART ON DELIVERY POINT F4
  - (4) DELIVERY PROX LOOP
  - (5) PICKUP PROX LOOP
  - (6) VSU BLOCKING LOOP AT EXIT

DATE: 10/12/89	JOB # 135	SCL 1160
PLSE BY: <i>WVA</i>	DWN BY: WAGNER	
TOL: .XX ± J2	.XX ± .06	.XXX ± .020
<b>APOGEE ROBOTICS</b>		
TITLE: P/D OPERATION		
DWG NO: B-5100-0185		

Figure 3-36 P&D Operation

*HOUSING UNIT.*